

Mrs Dean's story

Christine Ewin (Consumer)

Nicola Follett (Falls Prevention Coordinator)

Rebekah O'Reilly (NUM Batemans Bay Hospital)



Health
Southern NSW
Local Health District

Current situation – the research tells us...

- Falls can have serious consequences for older people, their families and carers.
- They can lead to reduced quality of life, disability, reduced physical activity, social isolation, functional decline and even death. (NSW Health 2014)
- Falls are one of the major factors in precipitating admission to RACF's. (ACQSHC 2009)



Impact of dementia on fall-related injury

People with dementia are 3-fold more likely to have hip fractures

People with dementia are 2-fold more likely to have head injuries

People with dementia are disproportionately represented in injury related hospitalisations, experience longer LOS and generally poorer outcomes.

People with dementia have higher mortality rates following hospitalisation than those without dementia. In a recent Australian study by Harvey (2015) the mortality rate was up to 4.5 times higher for people with dementia than for those without.





15th December 2014

ED admission following fall at home



Health
Southern NSW
Local Health District

17th December 2014

Admitted to HDU following second fall at home



Health
Southern NSW
Local Health District

18th December 2014
Following the fall in hospital



Health
Southern NSW
Local Health District

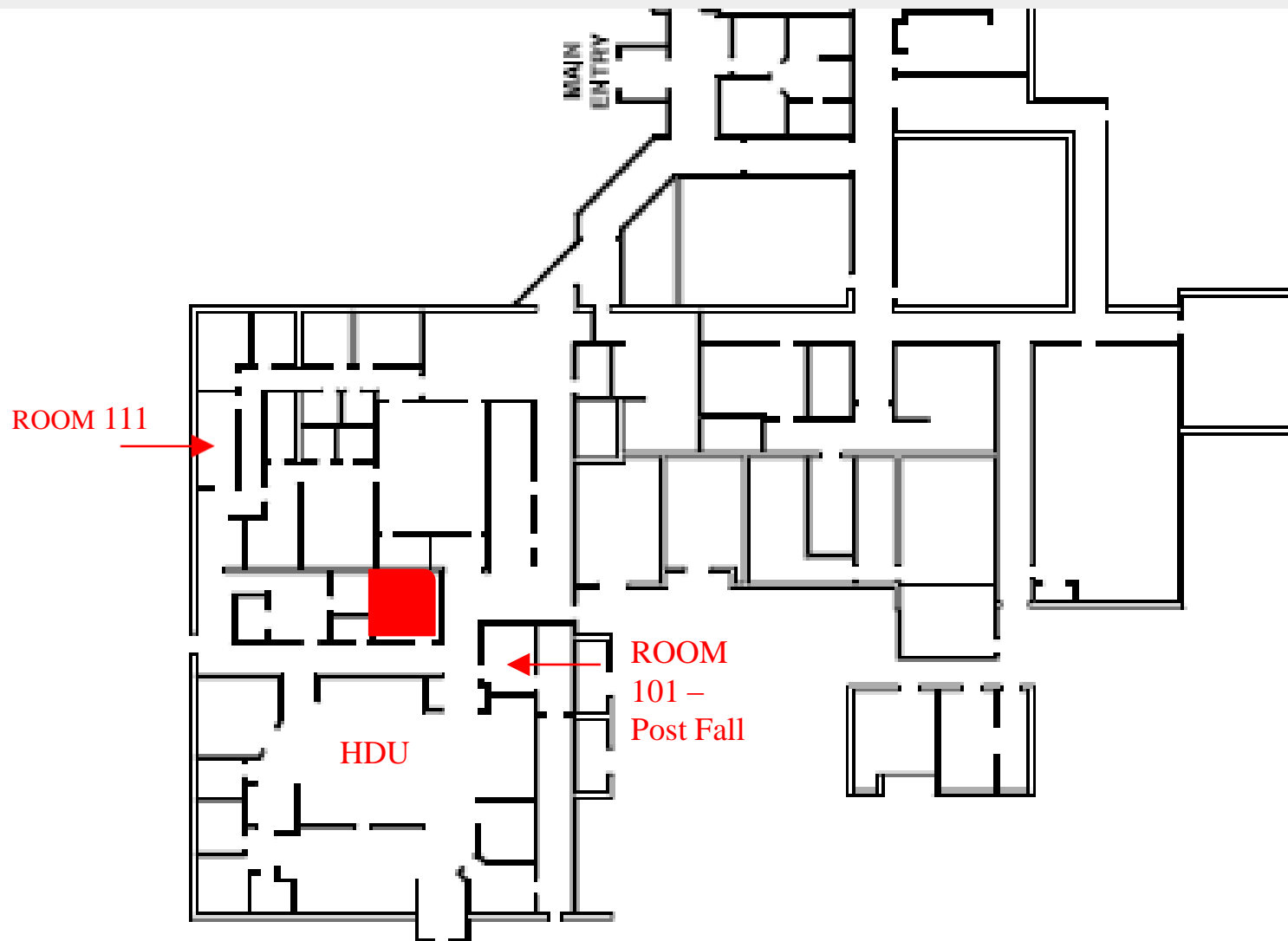

BATEMANS BAY HOSPITAL

- FLOOR PLAN -

20th December 2014
Post fall delirium



Health
Southern NSW
Local Health District

23rd December 2014



Health
Southern NSW
Local Health District

January-February 2015



Health
Southern NSW
Local Health District

March- April 2015



Health
Southern NSW
Local Health District

May 2015



Health
Southern NSW
Local Health District

What have we done?

There has not been a fall with serious injury at Batemans Bay hospital for two years.

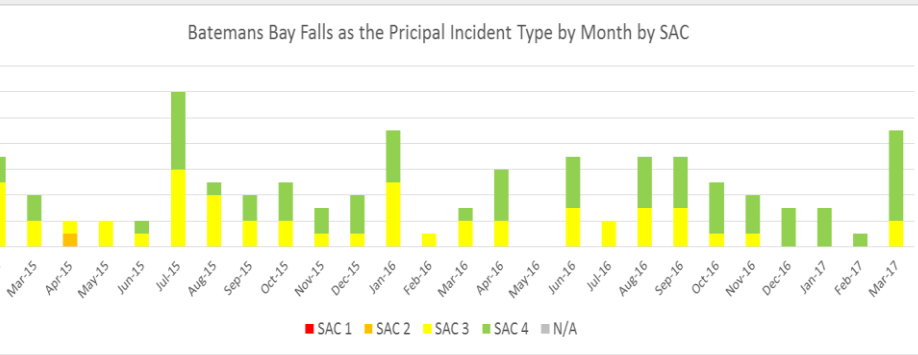
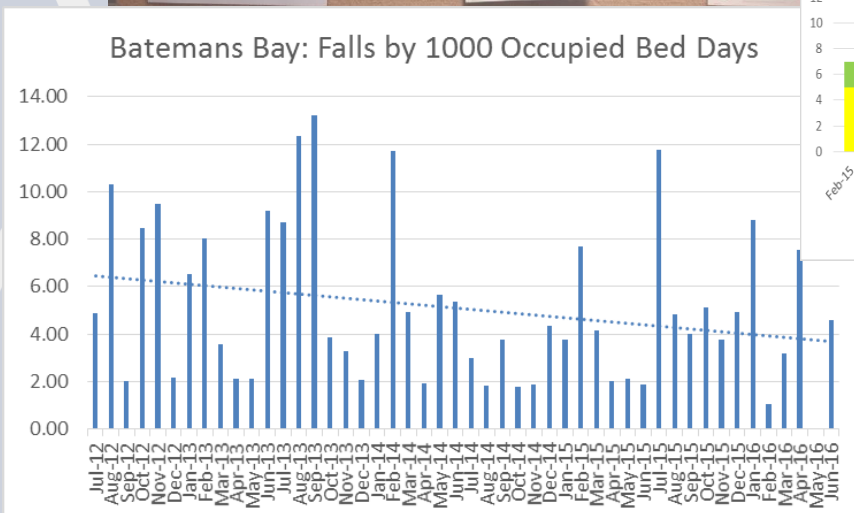
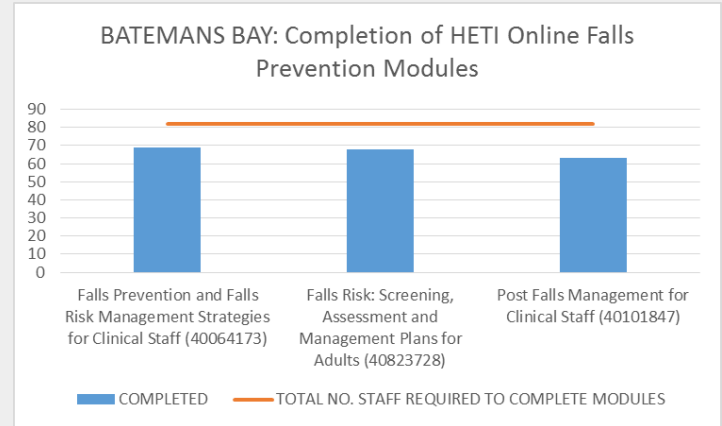

Health
Southern NSW
Local Health District

HOW DO I CALL FOR AN EMERGENCY RESPONSE?

We encourage you to first speak with your treating nurse who may be able to help you to resolve your concerns.

In this facility you can directly call an advanced nurse to request an emergency response by calling **02 44751643** on your mobile phone.

WILL I OFFEND STAFF IF I R.E.A.C.H. OUT?

No. Staff in this facility support patient and carer involvement. You know how you feel or how your loved one usually behaves.

We also encourage you to raise your concerns with us during times of handover between staff shifts.

We want you to work with us to create the best experience for you or your loved ones.

R.E.A.C.H out to us because together we make a great team

Are you worried about a recent change in your condition or that of your loved one?

R.E.A.C.H out to us

EUROBODALLA HOSPITALS

The REACH program was developed by the NSW Clinical Excellence Commission's Partnering With Patients Program



EUROBODALLA HOSPITALS

Are you concerned about a recent change in your condition or that of your loved one?

- Have you spoken to your nurse or doctor about this change?
- Have your concerns been followed up?
- Are you still concerned?

Ask your nurse for a 'clinical review' or dial 02 44751643 to call an emergency response team

We know that you know yourself or your loved one best.
REACH out to us if you are concerned.
Together we make a great team.

EUROBODALLA
HOSPITALS



System Improvements

- Post Fall Safety Huddles
- Additional audits to ensure screening, assessment & care planning are completed
- Introduction of non slip socks for all patients with falls risk
- Falls & delirium screening in EMR as a mandatory field
- Automatic flagging of falls risk status on the electronic journey boards
- Patient communication boards in each room



Thankyou



Health
Southern NSW
Local Health District